

VAUGHAN

ZURICH LANTERN COLLECTION

Fine brass castings show off the Zurich lantern to its limitless potential. It takes center stage regardless of size or style.

All permutations available in cast brass, bronze plated brass, or nickel plated brass.

CL0211.BR, CL0211.NI & CL0211.BZ
Zurich Ceiling Lantern, Small
Brass, Nickel or Bronze with shade
H. 20¼" W 13¼"

CL0237.BR, CL0237.NI & CL0237.BZ
Zurich Ceiling Lantern, Large
Brass, Nickel or Bronze with shade
H. 23" W 16¼"



VAUGHAN

ZURICH LANTERN COLLECTION



CL0111.BR, CL0111.NI & CL0111.BZ
Zurich Ceiling Lantern, Small
Brass, Nickel or Bronze
H. 20¼" W 13¾"

CL0236.BR, CL0236.NI & CL0236.BZ
Zurich Ceiling Lantern, Large
Brass, Nickel or Bronze
H. 23" W 16¼"

Zurich Ceiling Lantern with fixed rod
Available in Large & Small
Brass, Nickel & Bronze
with or without shade
Supplied with 14¼" rod
which can be reduced to
a minimum of 7"



The fixtures can also be
vertically linked to hang
through a stairwell.



VAUGHAN

COMPLETE ZURICH LANTERN COLLECTION

CL0111.BR
CL0111.NI
CL0111.BZ

Zurich Ceiling Lantern, Small
Brass, Nickel or Bronze
H. 20 1/4"
W. 13 3/4"

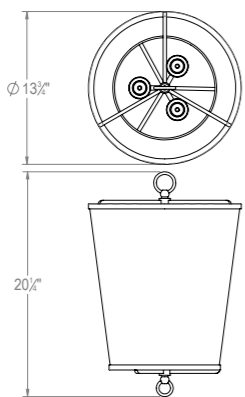
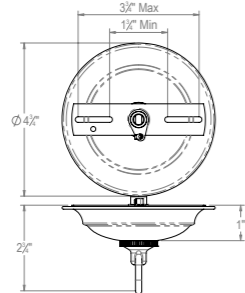

CL0211.BR
CL0211.NI
CL0211.BZ

Zurich Ceiling Lantern, Small
Brass, Nickel or Bronze
with shade
H. 20 1/4"
W. 13 3/4"

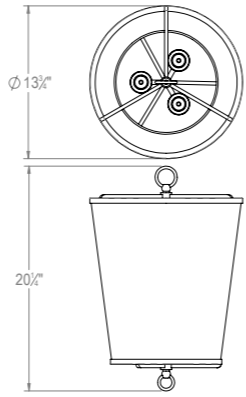
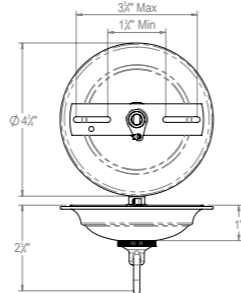

CL0293.BR
CL0293.NI
CL0293.BZ

Zurich Ceiling Lantern, Small
Brass, Nickel or Bronze
with fixed rod
H. 32 3/4"
W. 13 3/4"
Supplied with 14 1/4" rod
which can be reduced
to a minimum of 7"

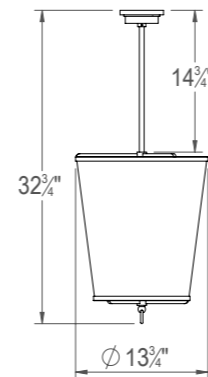

CL0294.BR
CL0294.NI
CL0294.BZ

Zurich Ceiling Lantern, Small
Brass, Nickel & Bronze
with shade or fixed rod
H. 32 3/4"
W. 13 3/4"
Supplied with 14 1/4" rod
which can be reduced
to a minimum of 7"

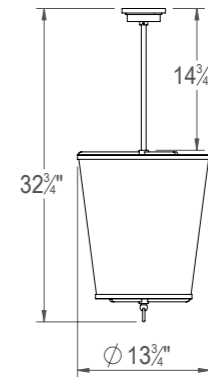

CL0236.BR
CL0236.NI
CL0236.BZ

Zurich Ceiling Lantern, Large
Brass, Nickel or Bronze
H. 23"
W. 16 1/4"

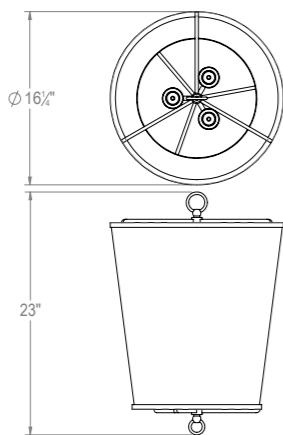
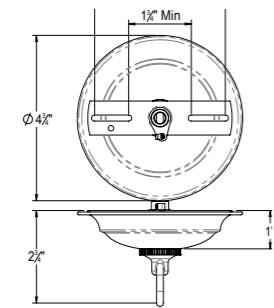

CL0237.BR
CL0237.NI
CL0237.BZ

Zurich Ceiling Lantern, Large
Brass, Nickel or Bronze
with shade
H. 23"
W. 16 1/4"

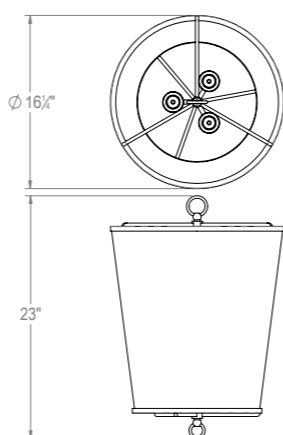
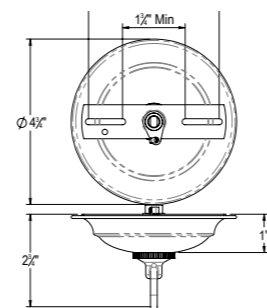

CL0295.BR
CL0295.NI
CL0295.BZ

Zurich Ceiling Lantern, Large
Brass, Nickel or Bronze
Fixed rod
H. 35 1/4"
W. 16 1/4"
Supplied with 14 1/4" rod
which can be reduced
to a minimum of 7"

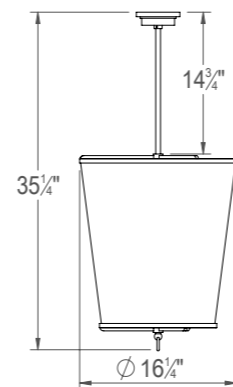

CL0296.BR
CL0296.NI
CL0296.BZ

Zurich Ceiling Lantern, Large
Brass, Nickel or Bronze
with shade & fixed rod
H. 35 1/4"
W. 16 1/4"
Supplied with 14 1/4" rod
which can be reduced
to a minimum of 7"

